



RY01~~**KKDU-4PU**~~

Royal Series

~~**USA Single Gang Box Standard**~~**Proximity**

Reader



Metallic Housing
Vandal Resistant
Weather Proof – IP65



Silver or Rose Gold Housing (custom colors available)



Backlit Touchkeys and OLED Display



Large Bright Indicator – Blue / Green light



RY01KPU

RY02U RY02KDU RY02KU

* - Card Number Only

® - Brands and Trademarks mentioned are the property of their owners.

Features



Multi-~~Prox~~ Technology ~~Card~~ ~~Readery~~

- ~~P~~ 13.56MHz – HF, Mifare, DesFire, NFC, PKI Encrypted, CPU, FIPS-201*125KHz –
LF, RF, EM, TK, ~~HID Prox.~~, ~~AWID~~ and others ~~KKID~~

Output Options:



-- Wiegand 26 & 34Bits Output, Field Selectable – 4-6 Wire,

-- RS-485 output (Model: RY01KP-4) - 2 wire secured communication, up to 4000ft.

distance

RS-485 output – 2 wire secured communication, up to 4000ft. distance



Low Power consumption



Single “Gang” Europe size – USA Europe & Chinese Standard

Specification

Model	P	<u>U</u>
-------	---	----------

Frequency	125KHz	13.56MHz <u>13.56MHz</u>
Technology	LF, TK, EM, AWID, HID Prox. and more	HF, Mifare, Desfire, PKI Encrypted, NFC, CPU, FIPS-201*, and more <u>HF, Mifare, Desfire, PKI Encrypted, NFC, CPU, FIPS-201*, and more</u>
Encryption	Manchester	3Des <u>3Des</u>
Read Range	~4'	~2' - 2' <u>~2' - 2'</u>
Power	7 – 15 Vdc	
Current – No Display	≤50mA <u>≤80mA</u>	
Current with Display	≤80mA <u>≤150mA</u>	
Temperature	-4°F - 150°F	
Humidity	95% RH	
Dimension	2¾" × 4¾" × 1¼" <u>2¾" × 4¾" × 1¼"</u>	

R Y 02 K D P 4

Reader Protocol –

4: RS-485

_ : Wiegand

Card Type

P: 125KHz – LF, TK, EM, HID Prox., AWID, and more

U: 13.56MHz – HF, NFC, Mifare, PKI Encrypted, CPU, FIPS-201* and more

D: Desfire, WG66

Features:

_ : Card Reader Only

K: Card Reader & Keypad

KD: Card Reader with Keypad and OLED Display

Mounting

01: EU 86×86 Box

02: USA Gang Box

Network Diagram

系统图

Network

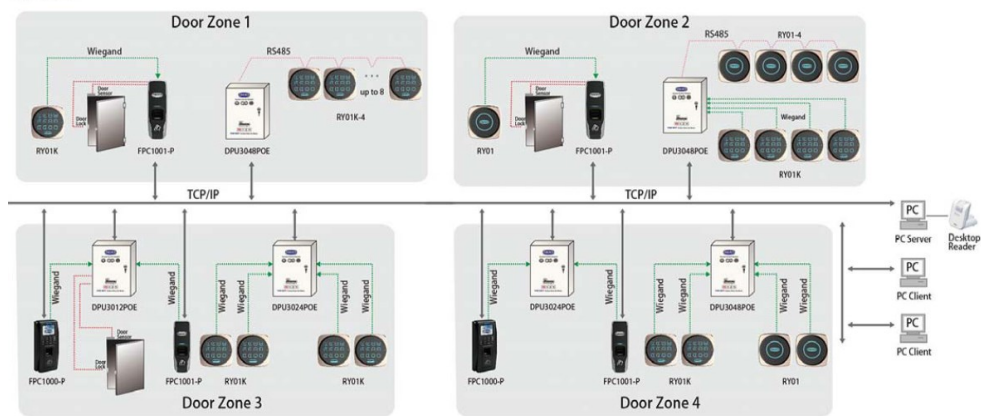

系统图

